

Shield oil-side
(Additional accessories)
LF 170 046-U or
LF 170 046-UP

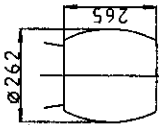

Shield SF6-side
(Additional accessories)
LF 170 046-F

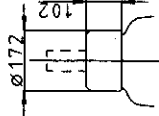

Pressure supervision equipment
LF 410 024-K or LF 410 024-L
(Additional accessories)

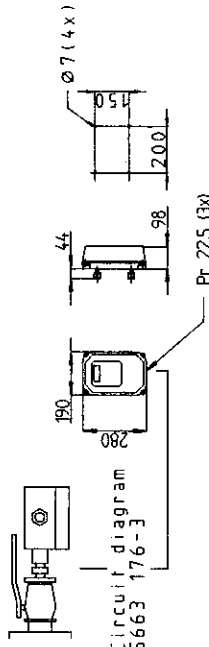

Terminal stud SF6-side
(Additional accessories)
LF 170 050-AA (Al)
or
LF 170 050-AL (Cu/Ag)

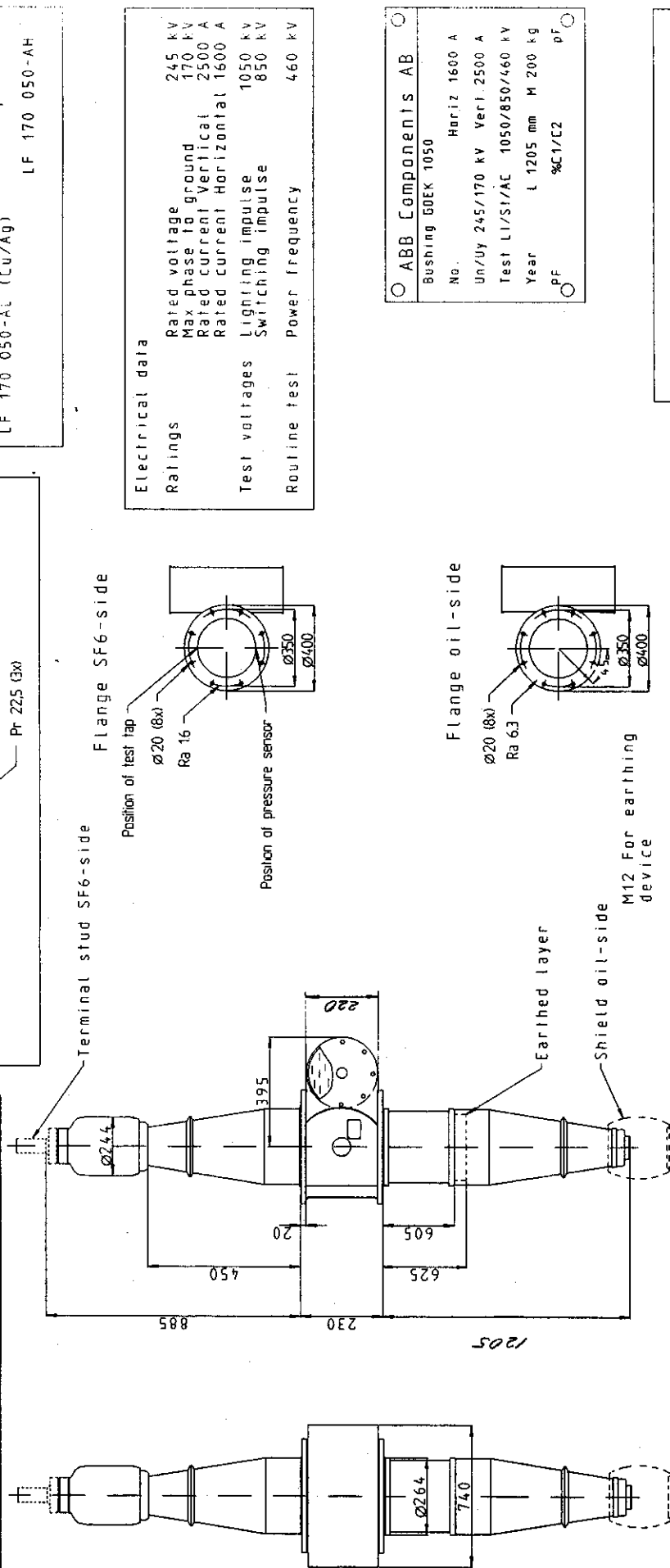
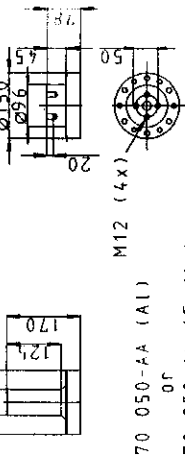

Electrical data

Ratings	Rated voltage	245 kV
	Max phase to ground	170 kV
	Rated current Vertical	2500 A
	Rated current Horizontal	1600 A
Test voltages	Lighting impulse	1050 kV
	Switching impulse	850 kV
Routine test	Power frequency	460 kV

ABB Components AB

Bushing	60EK 1050
No.	Hariz 1600 A
Un/ly	245/170 kV Vert. 2500 A
Test LI/SI/AE	1050/850/460 kV
Year	L 1205 mm M 200 kg
PF	%C1/C2
	pF

Catalogue number: LF 124 011-C

Accepted by quot	Accepted for prod by	Description (English)	DATA ORIGINAL
Design checked by Heyman	Drawn by Andersson	GOEK 1050 FE=600	File name
Drawing checked by Jonsson	Issued by Year/Week COM/BK 94 31	Description (Swedish)	Lang Sheet
2753 015-30			Rev Cont

Rev Ind	Revision	Appd	Year	Week
1	280.0411-1205.wps 9-5-14			31 31



We reserve all rights in this document. In the information contained therein. Reproduction, use or disclosure to third parties without express authority is strictly forbidden.
© ABB 19

Drawn by	Form No
Design checked by	Dept
	Year
	Cont